



January 18, 2022

Mr. Mathew Hudson  
Supervisor of Buildings and Grounds  
Manasquan Board of Education  
169 Broad Street  
Manasquan, New Jersey 08736

Re: Summary Report  
Lead in Water Testing and Analysis

Facility: Manasquan Alternative School  
167 Broad Street  
Manasquan, New Jersey

EC Project #: 20435-01

Environmental Connection, Inc., (EC) was contracted by the Manasquan Board of Education to collect and provide laboratory analysis of representative water samples from the Manasquan Alternative School, located at 167 Broad Street in Manasquan, New Jersey. Sampling was completed on December 29, 2021, between the hours of 5:45 AM and 5:50 AM during a period when the building was unoccupied.

Samples were collected from 2 locations, as follows:

| <b>Table 1- Lead in Water Sample Locations</b><br><b>Manasquan Alternative School</b><br><b>167 Broad Street, Manasquan, New Jersey</b><br><b>December 29, 2021</b> |                        |
|---|------------------------|
| Water Chiller Fountain in Classroom   | Sink Faucet in Kitchen |

Samples were collected in sterile 250 milliliter bottles, pre-treated with nitric acid solution (HNO<sub>3</sub>). The samples were delivered to EMSL Analytical, Inc. (EMSL) of Cinnaminson, New Jersey, on December 29, 2021. EMSL is certified by the State of New Jersey, Department of Environmental Protection (NJDEP), for drinking water analysis.

Analysis was completed in accordance with United States Environmental Protection Agency (USEPA) Method 200.8. The USEPA and NJDEP Action Level of 15 parts per billion (ppb) or micrograms per liter (µg/L) was used to determine if further testing and/or remediation is warranted.

Results of analysis are summarized in Table 2 below.



**Table 2- Lead in Water Results of Analysis  
Manasquan Alternative School  
167 Broad Street  
Manasquan, New Jersey**

| Sample # | Sample Location                     | Parameter     | Results of 1 <sup>st</sup> Draw Sample (ppb) | Results of 2 <sup>nd</sup> Draw Sample (ppb) | USEPA and NJDEP Action Level (ppb) |
|----------|-------------------------------------|---------------|--|--|------------------------------------|
| 01       | Water Chiller Fountain in Classroom | Lead in Water | <1.00  | N/A  | 15                                 |
| 02       | Sink Faucet in Kitchen              | Lead in Water | <1.00  | N/A  | 15                                 |

All samples were below the USEPA and NJDEP Action Level of 15 ppb. No remedial actions are required at this time.

Should you have any questions or require additional information, please contact the undersigned at your convenience.

Respectfully Submitted:  
ENVIRONMENTAL CONNECTION, INC.

Mike Moore  
Project Manager

Attachment 1: Analytical Report, Chain of Custody for Lead in Water Sampling and Sample Location Plan

**ATTACHMENT I**

**Analytical Report, Chain of Custody for Lead in Water Sampling and Sample Location  
Plan**



**EMSL Analytical, Inc.**

200 Route 130 North, Cinnaminson, NJ 08077

Phone: (856) 303-2500 Fax: (856) 858-4571 Email: EnvChemistry2@emsl.com

---

Attn:

**Jordan Reed**  
**Environmental Connection, Inc.**  
**120 North Warren Street**  
**Trenton, NJ 08608**

1/7/2022

Phone: (609) 392-4200  
Fax:

The following analytical report covers the analysis performed on samples submitted to EMSL Analytical, Inc. on 12/30/2021. The results are tabulated on the attached data pages for the following client designated project:

**Alternative School (Manasquan BOE)**

The reference number for these samples is EMSL Order #012200024. Please use this reference when calling about these samples. If you have any questions, please do not hesitate to contact me at (856) 303-2500.

Approved By:

---

Phillip Worby, Environmental Chemistry  
Laboratory Director



The test results contained within this report meet the requirements of NELAP and/or the specific certification program that is applicable, unless otherwise noted.  
NELAP Certifications: NJ 03036, NY 10872, PA 68-00367, CA ELAP 1877

The samples associated with this report were received in good condition unless otherwise noted. This report relates only to those items tested as received by the laboratory. The QC data associated with the sample results meet the recovery and precision requirements established by the NELAP, unless specifically indicated. All results for soil samples are reported on a dry weight basis, unless otherwise noted. This report may not be reproduced except in full and without written approval by EMSL Analytical, Inc.

**EMSL Analytical, Inc.**

200 Route 130 North, Cinnaminson, NJ 08077

Phone/Fax: (856) 303-2500 / (856) 858-4571

<http://www.EMSL.com>[EnvChemistry2@emsl.com](mailto:EnvChemistry2@emsl.com)

EMSL Order: 012200024

CustomerID: ENVI65

CustomerPO:

ProjectID:

Attn: **Jordan Reed**  
**Environmental Connection, Inc.**  
**120 North Warren Street**  
**Trenton, NJ 08608**

Phone: (609) 392-4200

Fax:

Received: 12/30/2021 09:00 AM

Project: **Alternative School (Manasquan BOE)****Analytical Results**

**Client Sample Description** 01 **Collected:** 12/29/2021 **Lab ID:** 012200024-0001  
 1st Floor / Classroom / Water Chiller Fountain / 1st Draw 5:44:00 AM

| Method        | Parameter | Result | RL Units | Prep Date & Analyst | Analysis Date & Analyst |
|---------------|-----------|--------|----------|---------------------|-------------------------|
| <b>METALS</b> |           |        |          |                     |                         |
| 200.8         | Lead      | ND     | 1.00 ppb | 1/5/2022 KB         | 1/5/2022 20:52 KB       |

**Client Sample Description** 02 **Collected:** 12/29/2021 **Lab ID:** 012200024-0002  
 1st Floor / Kitchen / Sink Faucet / 1st Draw 5:45:00 AM

| Method        | Parameter | Result | RL Units | Prep Date & Analyst | Analysis Date & Analyst |
|---------------|-----------|--------|----------|---------------------|-------------------------|
| <b>METALS</b> |           |        |          |                     |                         |
| 200.8         | Lead      | ND     | 1.00 ppb | 1/5/2022 KB         | 1/5/2022 20:54 KB       |

**Client Sample Description** 03 **Collected:** 12/29/2021 **Lab ID:** 012200024-0004  
 Blank

| Method        | Parameter | Result | RL Units | Prep Date & Analyst | Analysis Date & Analyst |
|---------------|-----------|--------|----------|---------------------|-------------------------|
| <b>METALS</b> |           |        |          |                     |                         |
| 200.8         | Lead      | ND     | 1.00 ppb | 1/5/2022 KB         | 1/5/2022 21:00 KB       |

**Definitions:**

MDL - method detection limit

J - Result was below the reporting limit, but at or above the MDL

ND - indicates that the analyte was not detected at the reporting limit

RL - Reporting Limit (Analytical)

D - Dilution Sample required a dilution which was used to calculate final results



# ENVIRONMENTAL CONNECTION INC

A Vertical Technologies Corporation

## Potable Water Sampling for Lead Concentration Sample Collection Form

### Client Information

|              |                  |
|--------------|------------------|
| Name:        | Mansueto BoE     |
| Address:     | 167 Broad Street |
| Client Rep.: | Matthew Hudson   |

### School Project Information

|                         |                              |                              |                              |                              |
|-------------------------|------------------------------|------------------------------|------------------------------|------------------------------|
| Building Id:            |                              |                              |                              |                              |
| Building No./Name:      | Alternative School.          |                              |                              |                              |
| Building Address:       |                              |                              |                              |                              |
| Contact Name & Numbers: |                              |                              |                              |                              |
| (0)Yr. Built            | (1)Yr. 1 <sup>st</sup> Add.: | (2)Yr. 2 <sup>nd</sup> Add.: | (3)Yr. 1 <sup>st</sup> Mod.: | (4)Yr. 2 <sup>nd</sup> Mod.: |

Inspector(s): M. Moore Date of Sampling: 12/29/21 12:21/21

### Sample Data

| Sample Description ID (ID Must Match Container Label) |       |                       |       |             |                |                    | Outlet Information                  |                    |           | Results    |                            |                  |
|---|-------|-----------------------|-------|-------------|----------------|--------------------|-------------------------------------|--------------------|-----------|------------|----------------------------|------------------|
| Sample #  | Floor | Functional Space Code | IN/BY | Room Number | Construc. Code | Sample/Outlet Code | Sampled Outlet Location/Coordinates | MFS/Model Serial # | 0 Seconds | 30 Seconds | Time of Collection (24 Hr) | Lead Conc. (ppb) |
| 1 01  | 01    | Classroom             | in    | Classroom   | 0              | LD                 | Water Churn Fountain                |                    |           |            | 5:44                       |                  |
| 2 02  | 01    | Kitchen               | in    | Kitchen     | 0              | SF                 | Sink Faucet                         |                    |           |            | 5:45                       |                  |
| 3 502   | 01    | Kitchen               | in    | Kitchen     | 0              | SF                 | ↓                                   |                    |           |            | 5:46                       |                  |
| 4 03  | B     | Bottle                |       |             |                |                    | Blank                               |                    |           |            |                            |                  |

All Containers are pre-cleaned/pre-certified 250 ml plastic bottles preserved w/ HNO<sub>3</sub> @ pH<2 by field X or to be preserved by lab     

### Chain of Custody

|                    |                 |  |
|--------------------|-----------------|--|
| Relinquished By:   | Received By:    | Date/Time:                                       |
| <i>[Signature]</i> | Eliezer COURIER | 12/29/21<br>12/29/21 7:45 PM<br>12/30/21 9:00 AM |

(4) Rec. preserved

Method of Shipment/delivery:      Fed-Ex      Hand Delivery  US Mail      UPS      Courier      Other:     

### Instructions to the Laboratory

|   |      |  |
|---|------|--|
| <input checked="" type="checkbox"/> Analyze "30 seconds" sample(s) <b>ONLY</b> when Initial sample exceeds 15 ppb<br><input type="checkbox"/> Analyze both initial and follow-up samples<br><input type="checkbox"/> Other: Follow QAPP | Lab: | Report Results To: Jordan Reed<br><input type="checkbox"/> Phone (609) 392-4200<br><input checked="" type="checkbox"/> Email jreed@vtihq.com<br><input type="checkbox"/> Fax: (609) 392-1216 |
|---|------|--|

Comments: Provide electronic and hard copy of Sample Chain of Custody with sample results and final analytical report.

TURN AROUND TIME REQUESTED: 1 WEEK



ENVIRONMENTAL CONNECTION INC  
A Vertical Technologies Corporation

Environmental Consulting, Auditing & Investigations

120 North Warren Street  
Trenton, NJ 08608

TEL: 609-392-4200 FAX: 609-392-1216  
EMAIL: info@vtihq.com WEB: www.VTIHQ.com

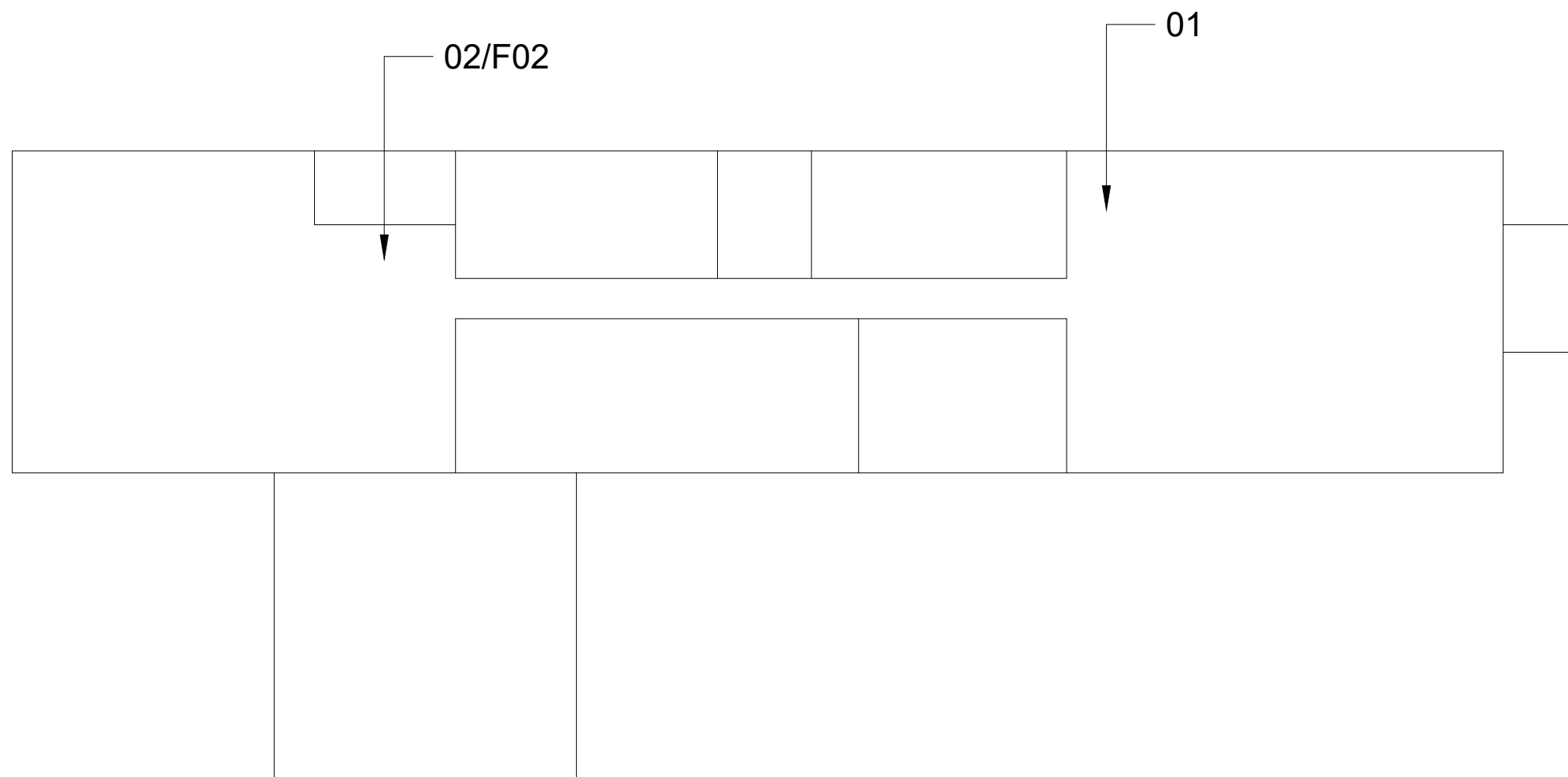

| 01  | 01/14/22 | Issued for Review |
|-----|----------|-------------------|
| No. | Date     | Issue or Revision |

LIW SAMPLE LOCATION PLAN  
 MANASQUAN BOARD OF EDUCATION  
 ALTERNATIVE SCHOOL  
 167 BROAD STREET, MANASQUAN, NJ

Date: 01/14/22

Scale: NTS

Drawn By: MEM

Project No: 20435-01

Drawing Title

SAMPLE LOCATION PLAN

Drawing No.

SL-01